

Get started with your SmartRock® sensors in these easy steps

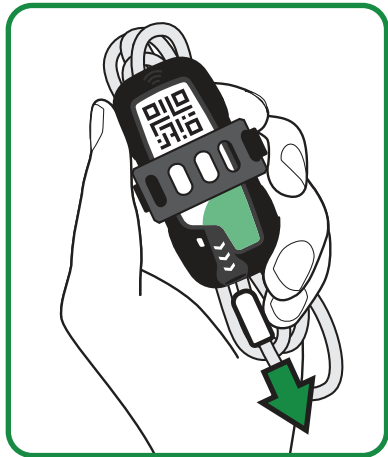

1 Remove the temperature probe from the sensor to activate

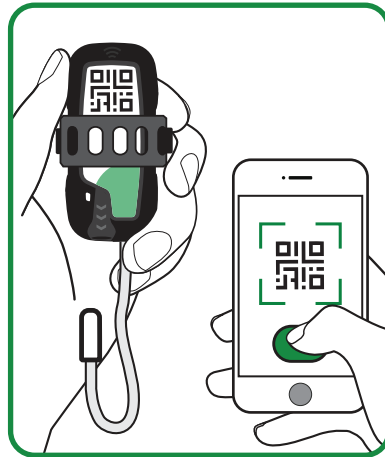

2 Add the sensor to your project by scanning the QR Code

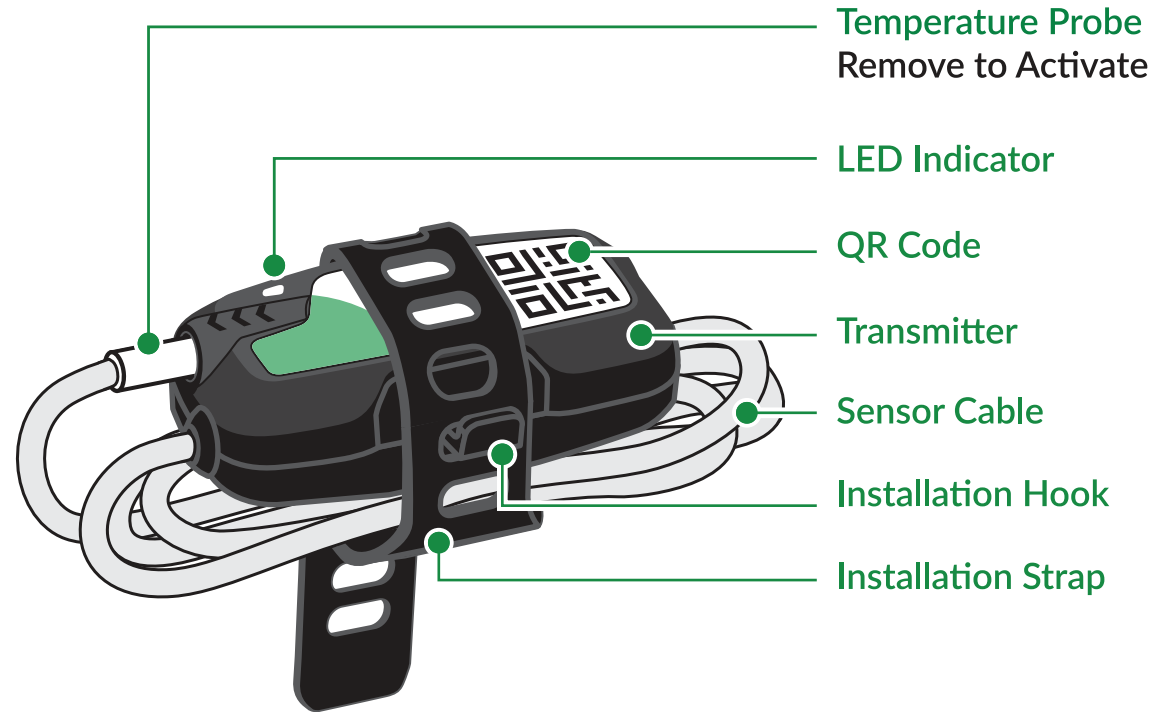

3 Assign the sensor a name in the mobile app and on its label

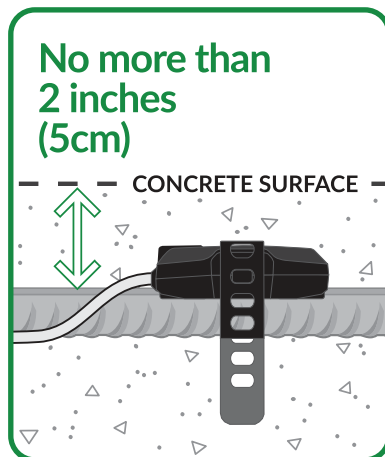

4 Install the transmitter on rebar no more than 2 inches (5cm) from concrete surface

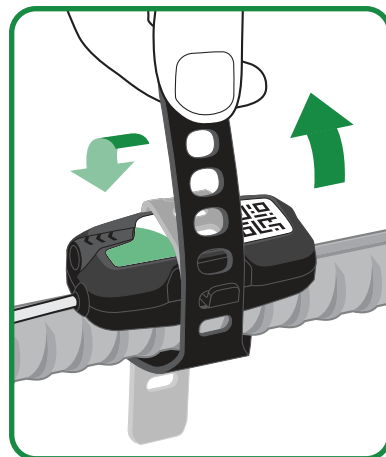

5 Pull strap tight over the installation hook and fold remaining strap over

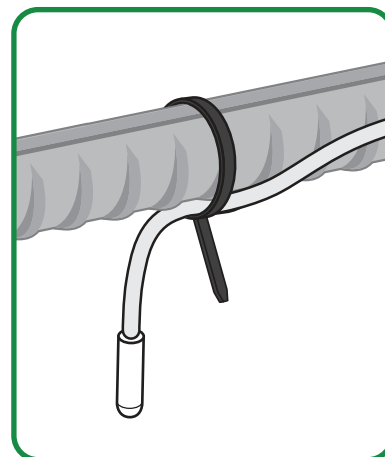

6 Secure the cable and temperature probe below the rebar



7 Pour concrete and monitor results in the mobile app or remotely with SmartHub™

 Using Giatec SmartRock® sensor in manners or conditions other than specified may cause damage to the sensor, compromise its safety or performance.

GIATEC SmartRock®

The World's #1 Wireless Concrete Sensor

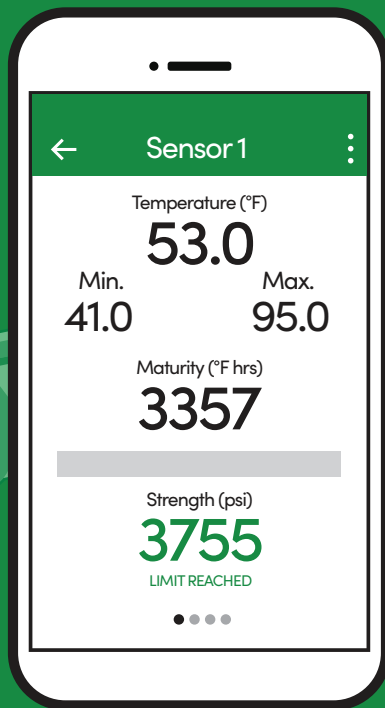

Need more sensors? Please contact us at:
sales@giatec.ca or +1 877-497-6278

Have
questions?

Contact us at
support@giatec.ca
+1 877-497-6278

! Have you updated your app?

Download the
SmartRock® mobile app
for iOS or Android